

Physio *Now you know*
logic *Soyez sûr*

Accuflex[®]5

Thermometer / Thermomètre

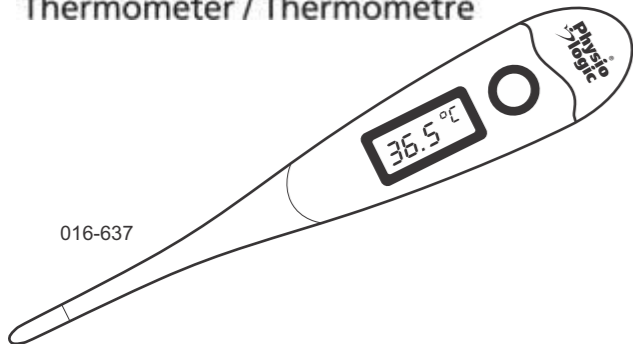

016-637

Instruction Manual

Features:

- For oral, rectal or underarm use
- Accurate within 0.1°C / 0.2°F
- Gentle-flex tip for added comfort & safety
- Backlit screen
- Keeps last 30 readings in memory
- Displays in Celsius or Fahrenheit
- Beep signals peak temperature
- Waterproof / washable for easy cleaning
- Auto shut-off for extended battery life

A.M.G. Medical Inc.
8505 Dalton, Montréal, QC H4T 1V5 Canada • 1-800-363-2381

AMG Medical, Inc. (USA)
8396 State Route 9, West Chazy, NY 12992, USA • 1-888-412-4992

Australian & NZ Distributor:
HMR Healthcare PL
Melbourne, VIC, 3189 Australia • 1800 363 238
www.amgphysiologic.com



Authorised Representative in the European Community :
M. Devices Group / E. C. REP Ltd,
Healthcare Education Centre, Portland Street, Southport, PR8 1HU, UK.
Tel: +44 1704 544 944 Fax: +44 1704 544 050 Email: info@ecrep.com

FRANÇAIS AU VERSO

What is a "normal" body temperature reading?

Although the generally accepted "normal" temperature is 37.0°C (98.6°F), it can vary from 36.1°C (97°F) to 37.2°C (99°F) and still be considered "normal". Variations in temperature can be attributed to activities such as exercise, smoking, eating and drinking. Even time of day may influence your temperature. For example, your temperature is lower in the morning than it is in the afternoon. Temperature also varies according to the chosen temperature reading site: while oral temperature follows the guidelines described above, rectal temperature is generally 0.6°C (1.0°F) higher, and axillary temperature 0.6°C (1.0°F) lower.

Features of your Accuflex[®] 5 digital thermometer

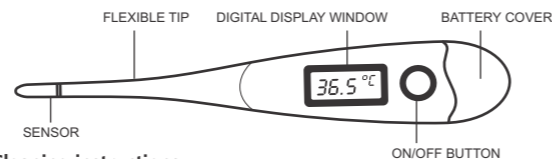

Cleaning instructions

Before and after each use, clean the thermometer with a soft cloth and 70% isopropyl alcohol diluted with water, or wash with COLD soapy water. An intact unit can be submersed in water or alcohol: however, do not soak in either for an extended period of time.

1. The unit must never be sterilized by boiling, gas or steam.
2. The use of any other solution or cleaning method beyond the above mentioned may result in reliability problems with the thermometer and void its warranty.

How to switch between °C and °F

1. Press the ON/OFF button, LCD shows 188.8^{°F} and then 1 M
2. Afterwards LCD shows L_M^{°C} (or L_M^{°F}) when M disappears, press the on/off button once more to change the measuring scale from °C to °F.

How to take your temperature

1. Clean and disinfect the thermometer according to the instructions provided.
2. Decide whether the measurement will be oral, rectal or underarm.
Note: Measurement time may vary based on the selected site.
3. Press the ON/OFF button (the unit will beep) to activate the thermometer.

First display symbols

 This is the LCD display test, which insures all parts of the display are functioning properly.

 The internal memory stores up to 30 readings. To consult, first press the ON/OFF button for 2 seconds until the screen shows 1 M (memory 1). Continue pressing the button to select a desired memory reading number (2 M, 3 M, 4 M...) then release it to get the corresponding stored reading.

 This display allows to switch between °C and °F. (See "How to switch between °C and °F")

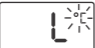
 When the °C or °F start flashing, it indicates that the thermometer is ready to take a temperature reading.

Note: When the temperature is above 32°C, the LCD will show green backlight.

Taking an oral temperature

Approximate measurement time:
5.2 seconds.

Note: Drinking hot or cold fluids, exercising, smoking or performing other activities may raise or lower your temperature. It is important to relax for approximately 5 minutes with your mouth closed prior to taking a reading.

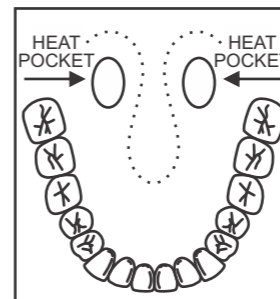

1. Using the diagram on the right, place the probe tip under the tongue as near as possible to a heat pocket.
Note: Your mouth must remain closed during the measurement for the reading to be as accurate as possible. Opening your mouth could result in an extended measurement time and may affect the reading.
2. The current temperature is shown and the °C or °F will continue to flash during the reading.
3. When the peak temperature has been reached, the °C or °F will stop flashing and the thermometer will beep 10 times.
4. To turn the unit off, press the ON/OFF button. The unit will automatically shut off after approximately ten minutes if it is not in use.

Taking an axillary temperature (under the arm)

Approximate measurement time: 7.1 seconds.

1. Wipe the underarm with a dry towel.
2. Place the probe tip under the arm so the tip is touching the skin, with the thermometer perpendicular to the body.
3. Position the arm across the chest so the probe tip is well covered by the arm. This also ensures that the probe is not affected by the room's air.
4. When the peak temperature has been reached, the °C or °F will stop flashing and the thermometer will beep ten times.
5. To turn the unit off, press the ON/OFF button. However, the unit will automatically shut off after approximately 10 minutes if it is not in use.
Note: Axillary temperatures are generally 0.6°C (1.0°F) lower than oral readings.

Taking a rectal temperature

Approximate measurement time: 5.0 seconds.

- Note:** Rectal temperatures are an appropriate and reliable method for infants and small children. Otherwise, this method should only be used when it is impossible or impractical to take an oral or axillary temperature.
1. Apply a water-soluble lubricant to the tip.
 2. Gently insert the probe to a MAXIMUM of 1/2" (1.25 cm) into the rectum.
 3. When the peak temperature has been reached, the °C or °F will stop flashing and the thermometer will beep ten times.
 4. To turn the unit off, press the ON/OFF button. However, the unit will automatically shut off after approximately 10 minutes if it is not in use.
Note: Rectal temperatures are generally 0.6°C (1.0°F) higher than oral readings.

General care

1. This thermometer should only be used under the supervision of an adult.
2. Do not walk, run or talk while using the thermometer.
3. Clean the thermometer before and after each use.
4. Store the unit in the protective case when not in use.
5. Do not bite the probe.
6. Do not store the unit where it will be exposed to direct sunlight, dust or humidity. Avoid extreme temperatures.
7. Dropping or subjecting your thermometer to strong shocks should be avoided.
8. Do not attempt to disassemble the unit, except to replace the battery.
9. If ERR displays and measurement is not attainable, the unit must be replaced.

Note: The use of probe covers may result in 0.1 °C (0.2 °F) of variation with actual temperature, and the measuring time will be longer.

Changing the battery

The battery in your digital thermometer needs to be replaced when the "  " symbol appears in the middle right of the display. Replace the battery with a 3.0 Vdc battery, type CR1632, CR1625, CR1620 or equivalent.

1. Slide the battery cap away from the unit.
2. Using a non-metal pointed tool, carefully remove the battery and insert the new battery with the positive (+) side up.
3. Carefully slide the battery cap back into place, making sure that the cap fits snugly to protect the battery compartment from moisture.

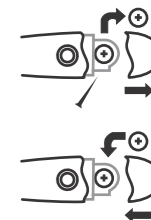

Note: Please properly dispose of the battery away from small children and heat.

WARNING: KEEP BATTERIES OUT OF REACH OF CHILDREN

Specifications

Display:	Liquid Crystal Display
Display resolution:	4 Digits (1/10th of a degree increments)
Measurement range:	32°C (89.6°F) to 42.9°C (109.3°F)
Accuracy:	± 0.1°C (0.2°F)
Average measurement time:	Oral: 5.6 seconds, rectal: 5 seconds, axillary: 6.9 seconds
Tone:	Thermometer beeps when activated and deactivated. A series of ten beeps signal when peak temperature is reached
Memory:	Displays last measured temperature
Battery:	One, 3.0 Vdc CR1632, CR1625, or CR1620
Battery life:	18 months for 10 minutes per day
Automatic shut-off:	After approximately 6 minutes
Ambient operating temperature:	10°C (50°F) to 40°C (104°F)(humidity: 10 % ~ 95 %)
Dimensions:	15.2 cm x 1.4 cm x 2.15 cm (5.98" x 0.55" x 0.84")
Weight :	16.8 grams with battery inside

Specifications are subject to change without notice.

Rev10 0718 P/N 861-016637